

| Parts List | | |
|------------|------------------------------|-----|
| STOCK No | DESCRIPTION | QTY |
| 2C1002 | Mk5 Catch Plate | 1 |
| 2C1801 | Cap Plastic 2 Start | 2 |
| 2F1204 | M8 Lock Nut | 2 |
| 2M1015 | Yellow Plastic Washer | 1 |
| 2N1006 | Yellow Cone Nozzle | 1 |
| 2P1003 | Green Plastic 'G2' Plunger | 2 |
| 2P1021 | Split Sachet Plunger | 1 |
| 2S1007 | Catch Plate Spring | 1 |
| 2S1021 | Release Plate Spring | 1 |
| 3P1006 | Steel 40mm 'Tin Hat' Plunger | 1 |
| 3R1493 | Release Plate | 1 |
| 3XR022 | WCD Sleeve | 1 |
| 7B1000 | Mk 5 Butt & Trigger Assembly | 1 |
| 7B8375 | Clear Barrel | 1 |
| 7R1011 | T Handle Rod 476mm | 1 |
| 7X1002 | Plastic Barrel Screw/Bushed | 1 |
| 7X1004 | Cox Wrench | 1 |
| 7XL001 | Ladder Hook Kit | 1 |

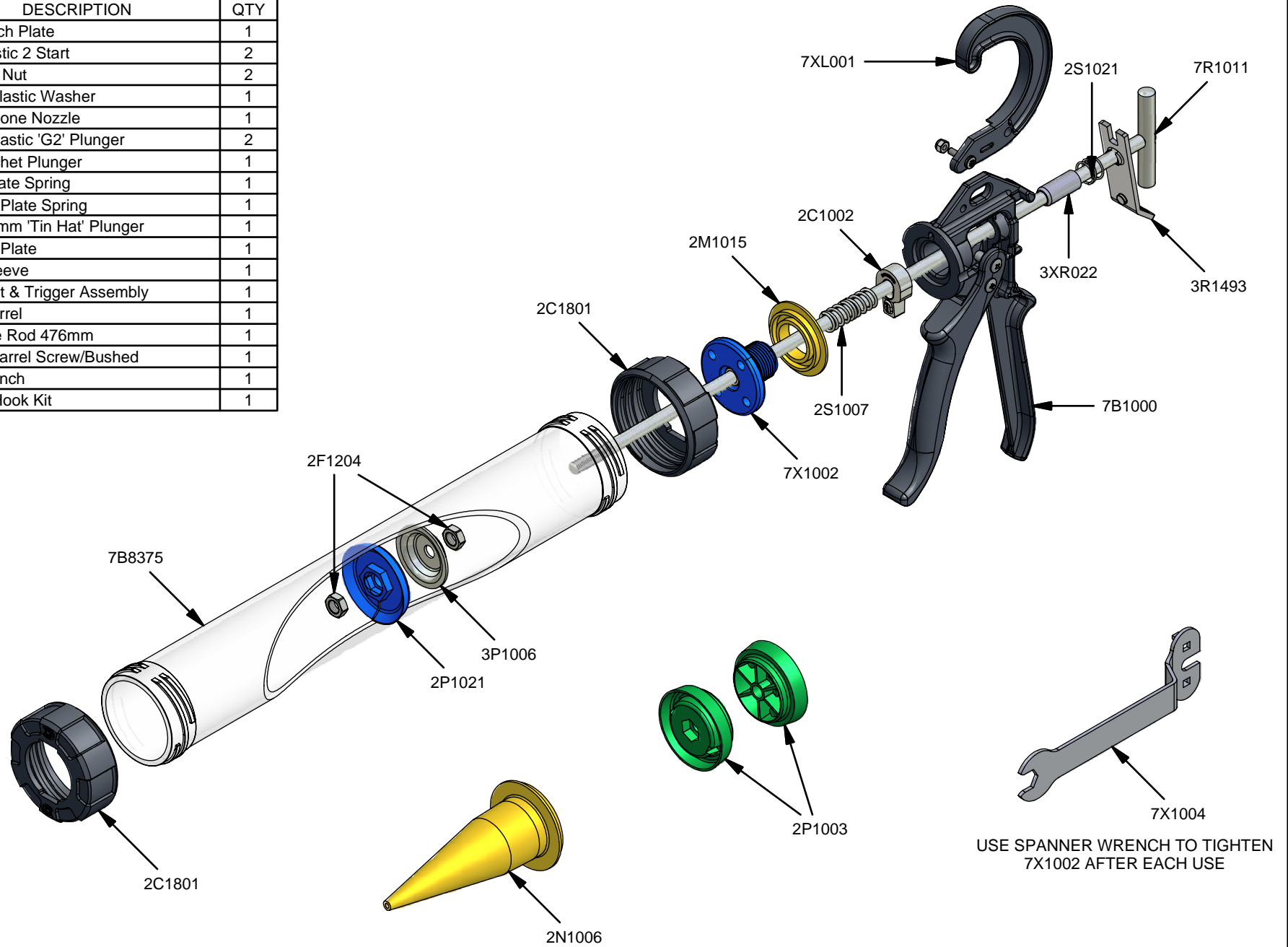

15" Sachet/Bulk Powerflow CB



www.cox-applicators.com
 sales@cox-applicators.com
 800-822-8114

REV
 B

DATE
 15/04/2008

